

Pump Performance Datasheet

Project name / location	:		Tag Number	:	001
Consulting engineer	:		Service	:	
Customer	:		Model	:	25709 VL
Customer ref. / PO	:		Quantity	:	4
Quote number	:	alan deal 8/3/16	Quoted By (Sales Office)	:	HS Buy Van Associates Inc.
Date last saved	:	08/03/2016 11:22 AM	Quoted By (Sales Engineer)	:	Randy Walker

Operating Conditions		Liquid	
Flow, rated	: 144.0 USgpm	Liquid type	: Cold Water
Differential head / pressure, rated (requested)	: 35.00 ft	Additional liquid description	:
Differential head / pressure, rated (actual)	: 34.98 ft	Solids diameter, max	: 0.00 in
Suction pressure, rated / max	: 0.00 / 0.00 psi.g	Solids concentration, by volume	: 0.00 %
NPSH available, rated	: Ample	Temperature, max	: 68.00 deg F
Frequency	: 60 Hz	Fluid density, rated / max	: 1.000 / 1.000 SG
		Viscosity, rated	: 1.00 cP
		Vapor pressure, rated	: 0.34 psi.a

Performance		Material	
Speed, rated	: 1765 rpm	Material selected	: Cast iron
Impeller diameter, rated	: 6.34 in		
Impeller diameter, maximum	: 7.10 in	Pressure Data	
Impeller diameter, minimum	: 5.00 in	Maximum working pressure	: 19.23 psi.g
Efficiency	: 71.32 %	Maximum allowable working pressure	: 175.0 psi.g
NPSH required / margin required	: 5.33 / 0.00 ft	Maximum allowable suction pressure	: 175.0 psi.g
nq (imp. eye flow) / S (imp. eye flow)	: 23 / 109 Metric units	Hydrostatic test pressure	: 263.0 psi.g
MCSF	: 40.00 USgpm	Driver & Power Data	
Head, maximum, rated diameter	: 44.42 ft	Motor sizing specification	: Max power (non-overloading)
Head rise to shutoff	: 26.82 %	Margin over specification	: 0.00 %
Flow, best eff. point	: 124.6 USgpm	Service factor	: 1.00
Flow ratio, rated / BEP	: 115.56 %	Power, hydraulic	: 1.27 hp
Diameter ratio (rated / max)	: 89.30 %	Rated power (based on duty point)	: 1.79 hp
Head ratio (rated dia / max dia)	: 71.07 %	Max power (non-overloading)	: 1.88 hp
Cq/Ch/Ce/Cn [ANSI/HI 9.6.7-2010]	: 1.00 / 1.00 / 1.00 / 1.00	Nameplate motor rating	: 2.00 hp / 1.49 kW
Selection status	: Acceptable		

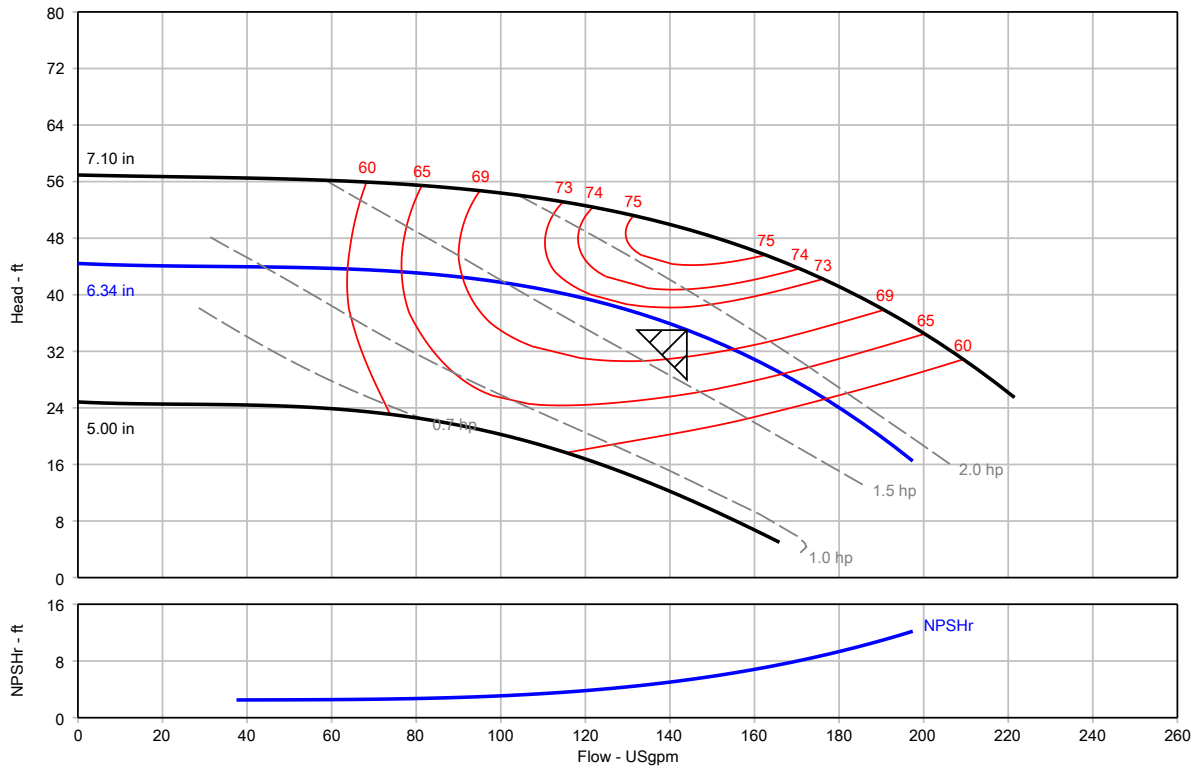

PACO Series VL In Line Centrifugal Pump, Close Coupled

PROJECT: alan deal 8/3/16	UNIT TAG: 001	QUANTITY: 4
REPRESENTATIVE:	SERVICE:	DATE:
ENGINEER:	SUBMITTED BY:	DATE:
CONTRACTOR:	APPROVED BY:	DATE:
	ORDER #:	DATE:



VL 25709
1765 rpm

Part Number: N/A

Conditions of Service		Pump Data		Motor Data	
Flow:	144.0 USgpm	Impeller Diameter:	6.34 in	Motor HP:	2.00 hp
Head:	35.00 ft	Max. Imp. Dia.:	7.10 in	BHP:	1.79 hp
Liquid:	Cold Water	Min. Imp. Dia.:	5.00 in	Enclosure:	TEFC
Temperature:	68.00 deg F	Efficiency:	71.32 %	Voltage:	208-230/460 V
NPSHr:	5.33 ft	Suction:		Phase:	3 Phase
Viscosity:	1.00 cP	Discharge:		Cycle:	60 Hz
Specific Gravity:	1.000 SG	Configuration:	Vertical	Frame Size:	145JM

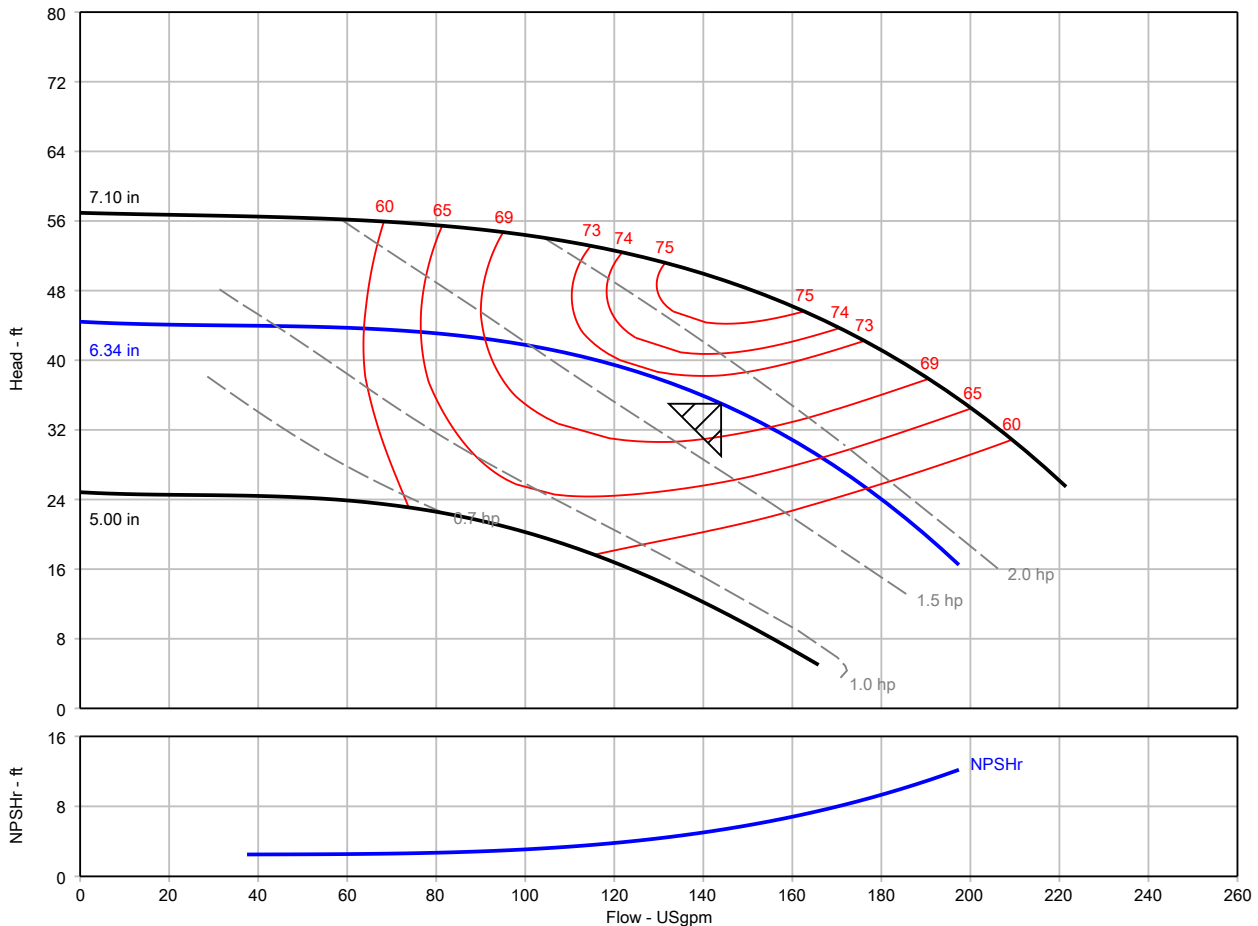

PACO Series VL In Line Centrifugal Pump, Close Coupled

Do not install pump larger than 215JM in vertical piping.

Pressure and drain tap locations are approximate.

Suction and discharge flanges, are cast per 250# ANSI thickness and diameter. All flanges are flat face. Some holes may be threaded because of nut clearances.

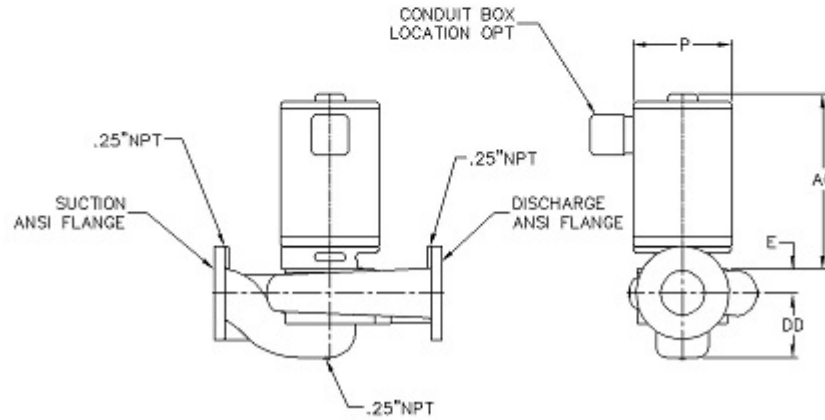

NOT FOR CONSTRUCTION, unless certified and referenced on order

Units	Frame	S x D	AG (Max)	DC	DD	DE	E	P (Max)	X	YY	Weight
inches	145JM	2.5 X 2.5	18.00	4.75	6.00	5.62	1.63	8.00	8.50	8.50	TBD

PACO Series VL In Line Centrifugal Pump, Close Coupled

PROJECT: alan deal 8/3/16	UNIT TAG: 001	: VL 25709
----------------------------------	----------------------	-------------------

MATERIALS OF CONSTRUCTION			
PART	MATERIAL	PART	MATERIAL
Rotation Options	Clockwise	Impeller Washer	S.S., AISI-303
Base/Stand Type	No Stand Provided	Impeller Key	Steel, AISI 1045
Connections	125# ANSI	Sleeve Material	Bronze, III932, C89835 or No Sleeves
Wear Ring Material	NiAl-Bronze, ASTM-B148, C95500	Wear Ring Type	Case Wear Ring
Pump Coatings	Standard Paint	Packing Gland	Not Applicable
NSF-50 Certification	Not Required	Lantern Ring	None
NSF-61 Certification	Not Required	Seal Type	Type 21
Motor Drip Canopy	Provided	Casing	Cast Iron, ASTM-A48, CL 30
Seal Material	Ceramic/Carbon/Buna	O-Rings	Buna N
Motor Shaft	Steel, AISI 1045 or S.S	Seal Flush Options	External Flush, plastic tubing
Backplate/Seal Plate	Cast Iron, ASTM-A48, CL 30	Motor Bracket	Cast Iron, ASTM-A48, CL 30
Gaskets	Vegetable Fiber	Impeller	Silicon Bronze, ASTM-B584, C87600
Casing Bolts	Steel, Grade 5	Impeller Cap Screw	S.S., AISI-303
Comments			

* All materials based on STANDARD configuration

Construction Datasheet

Project name / location	:	Tag Number	:	001
Consulting engineer	:	Service	:	
Customer	:	Model	:	25709 VL
Customer ref. / PO	:	Quantity	:	4
Quote number	:	Quoted By (Sales Office)	:	HS Buy Van Associates Inc.
Date last saved	:	Quoted By (Sales Engineer)	:	Randy Walker

Construction				Motor Information	
--------------	--	--	--	-------------------	--

Nozzle	Size (in.)	Nozzle Configuration	Pos'n	Manufacturer	: Baldor
Suction	2.5	125# ANSI	Side	Frame Size	: 145JM
Discharge	2.5	125# ANSI	Side	Power	: 2.00 hp
Orientation / Configuration	: Vertical			RPM	: 1800 rpm
Rotation	: Clockwise			Enclosure	: TEFC
Wear Ring Configuration	: Single - Case			Operating Power Supply	: 230/460/3/60
Discharge Elbow Size	: -			Efficiency	: Premium
Subplate	: -			Service factor	: 1.15
Sump Depth (feet)	: -			Motor Application	: General Purpose
Bearing Frame	: -			Motor Options/Accessories	: -
Bearing Frame Foot	: -			Cord Length (feet)	: -
Bearing Type (Radial/Thrust)	: In motor			Materials	
Bearing Lubrication	: Regreasable			Case	: Cast Iron, ASTM A48 - Class 30
Thrust Bearing	: -			Motor Bracket	: Cast Iron, ASTM-A48, CL 30
Intermediate Bearing	: -			Impeller	: Silicon Bronze, ASTM B584 C87600 (B21)
Lower Bearing	: -			Impeller Cap Screw and Washer	: Stainless Steel, AISI-303
Bearing Housing Accessories	: -			Impeller Key	: Steel, Cold Drawn C1018
PACO Construction code	: 16-25709-130101-2562P			Case wear ring	: Tin Bronze, ASTM B584-90500 (B18)

Baseplate, Coupling and Guard			
-------------------------------	--	--	--

Baseplate	:	Not Applicable	Impeller wear ring	:	-
Drip Pan	:	-	Pump Shaft	:	Steel, AISI-1040
Coupling	:	-	Sleeve	:	Bronze, III932, C89835
Guard	:	OSHA Approved	Line Shaft	:	-

Seal & Packing Construction			
-----------------------------	--	--	--

Sealing Method	:	Single Seal, Type 21S	Discharge Pipe	:	-
Seal Material	:	Buna Carbon Ceramic SS-Spring and Hardware	Discharge Elbow	:	-
Packing Gland	:	-	Suction Elbow	:	-
Lantern Ring	:	-	Subplate	:	-
Recirculation Lines	:	Nylon Tubing with Brass Fittings	Hardware	:	Steel, Grade 5
			O Rings	:	Buna N
			Pump Coatings	:	Standard Manufacturers Paint

Weights (Approx.)			
-------------------	--	--	--

Pump	:	91.00 lb	:	-
Baseplate	:	-		
Driver	:	53.00 lb		
Estimated Shipping gross weight	:	144.0 lb		

Pump Performance Curve

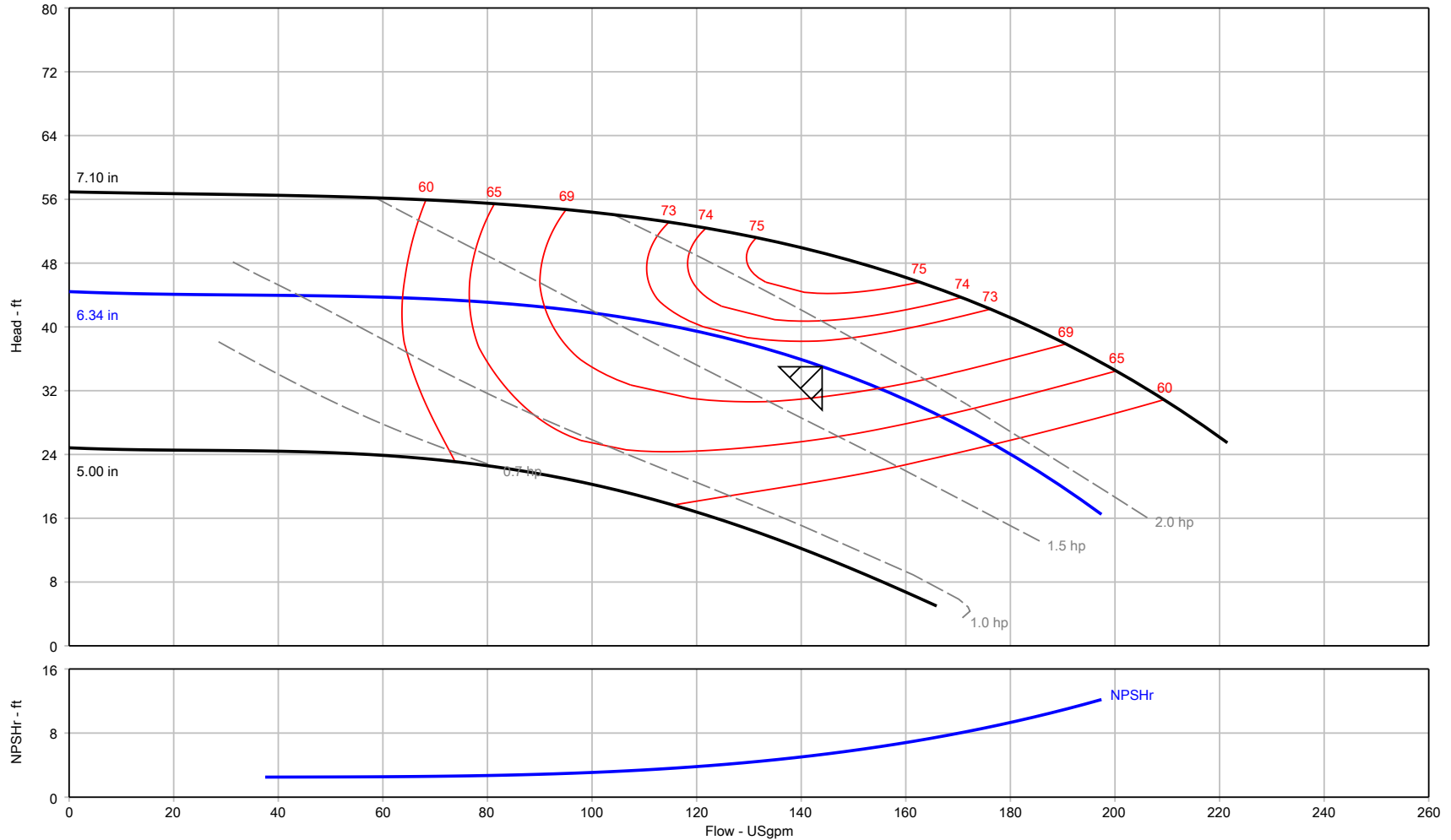

Project name / location :	Tag Number :	001	Speed, rated :	1765 rpm
Consulting engineer :	Service :		Flow, rated :	144.0 USgpm
Customer :	Model :	25709 VL	Differential head / pressure, rated :	35.00 ft
Customer ref. / PO :	Quantity :	4	Rated power (based on duty point) :	1.79 hp
Quote number : alan deal 8/3/16	Quoted By (Sales Office) :	HS Buy Van Associates Inc.	Max power (non-overloading) :	1.88 hp
Date last saved : 08/03/2016 11:22 AM	Quoted By (Sales Engineer) :	Randy Walker	Efficiency :	71.32 %
:	Stages :	1	Based on curve number :	RC9905-1 Rev 1

Position	Qty.	Description
	1	<p>ALPHA 15-55SF</p>  <p style="text-align: center;">Note! Product picture may differ from actual product</p> <p>Product No.: 59896879</p> <p>GRUNDFOS ALPHA The next generation of energy efficient circulators.</p> <p>ALPHA is the latest and most innovative member of the Grundfos family of high-quality circulators. By incorporating a permanent magnet motor design, power consumption is now reduced by 50%. ALPHA adapts to the seasonal demands of your system without sacrificing comfort.</p> <p>With ALPHA, you can stop worrying about complicated pump settings. Simply install the pump and leave it in the factory setting, AUTOADAPTTM. ALPHA will automatically analyze the heating system, find the optimum setting and continue to adjust its operation to changes in demand. The result is optimum comfort and minimum energy consumption.</p> <p>AUTOADAPT The factory setting, AUTOADAPT, analyses the heating system and automatically adjusts the pump setting to meet changes in heating demand. Ensuring lowest possible energy consumption, while maintaining maximum comfort levels.</p> <p>Compact design The innovative design makes ALPHA the most compact Grundfos circulator available. With the electronics integrated into the motor housing and standard 2-Bolt flange connection, confined spaces and challenging applications are now possible.</p> <p>Two options for power connections Option 1: 6-foot line cord with three prong plug Option 2: Conduit terminal box with push pin wire connection</p> <p>One-touch operation Intuitive one-touch operation for selecting seven different hydraulic settings. 3 Fixed Speeds 3 Constant Pressure settings AUTOADAPT</p> <p>LED Display The easy-to-read LED display indicating power (Watts) consumption and flow (GPM) estimation.</p> <p>Liquid: Pumped liquid: Water Liquid temperature range: 35.6 .. 230 °F Liquid temp: 140 °F Density: 61.35 lb/ft³</p> <p>Technical:</p>

Position	Qty.	Description
		<p>TF class: 110</p> <p>Approvals on nameplate: ETL, FCC</p> <p>Materials:</p> <p>Pump housing: Stainless steel DIN W.-Nr. 14308 ASTM CF8</p> <p>Impeller: Composite, PES</p> <p>Installation:</p> <p>Range of ambient temperature: 32 .. 104 °F</p> <p>Maximum operating pressure: 145 psi</p> <p>Pipe connection: G 1 1/2</p> <p>Pressure stage: PN 10</p> <p>Port-to-port length: 6 1/2 in</p> <p>Electrical data:</p> <p>Power input - P1: 5 .. 45 W</p> <p>Mains frequency: 60 Hz</p> <p>Rated voltage: 1 x 115 V</p> <p>Maximum current consumption: 0.1 .. 0.65 A</p> <p>Enclosure class (IEC 34-5): IP42</p> <p>Insulation class (IEC 85): F</p> <p>Others:</p> <p>Gross weight: 7.5 lb</p>

Description	Value
General information:	
Product name:	ALPHA 15-55SF
Product No:	59896879
EAN number:	5710620164390
Price:	On request
Technical:	
Head max:	18.05 ft
TF class:	110
Approvals on nameplate:	ETL, FCC
Materials:	
Pump housing:	Stainless steel DIN W.-Nr. 14308 ASTM CF8
Impeller:	Composite, PES
Installation:	
Range of ambient temperature:	32 .. 104 °F
Maximum operating pressure:	145 psi
Pipe connection:	G 1 1/2
Pressure stage:	PN 10
Port-to-port length:	6 1/2 in
Liquid:	
Pumped liquid:	Water
Liquid temperature range:	35.6 .. 230 °F
Liquid temp:	140 °F
Density:	61.35 lb/ft ³
Electrical data:	
Power input - P1:	5 .. 45 W
Mains frequency:	60 Hz
Rated voltage:	1 x 115 V
Maximum current consumption:	0.1 .. 0.65 A
Enclosure class (IEC 34-5):	IP42
Insulation class (IEC 85):	F
Motor protec:	NONE
Thermal protec:	ELEC
Controls:	
Pos term box:	6H
Others:	
Gross weight:	7.5 lb
Sales region:	USA

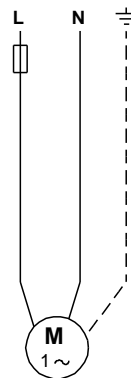
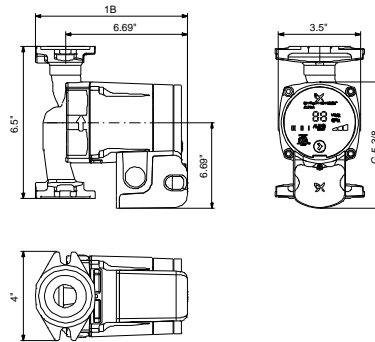
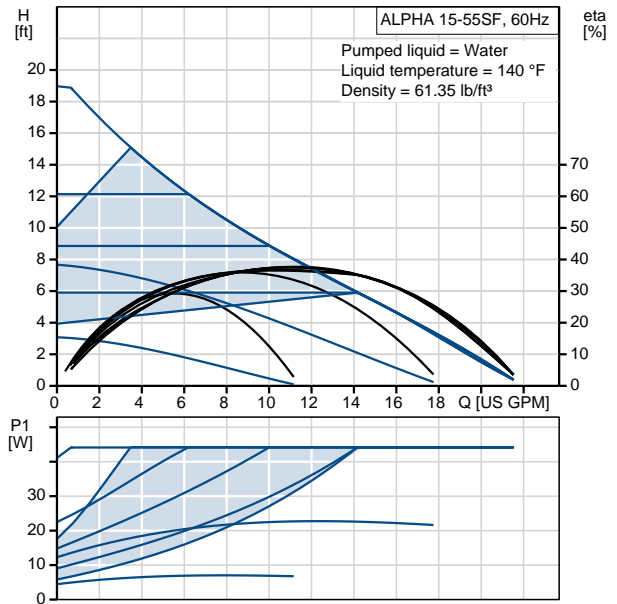

59896879 ALPHA 15-55SF 60 Hz

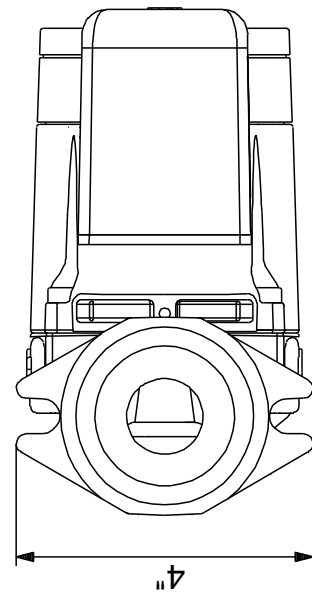
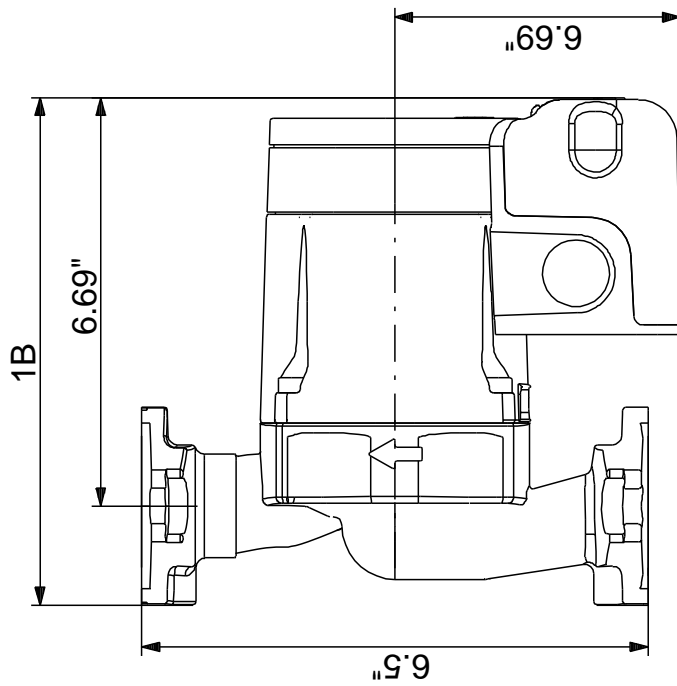
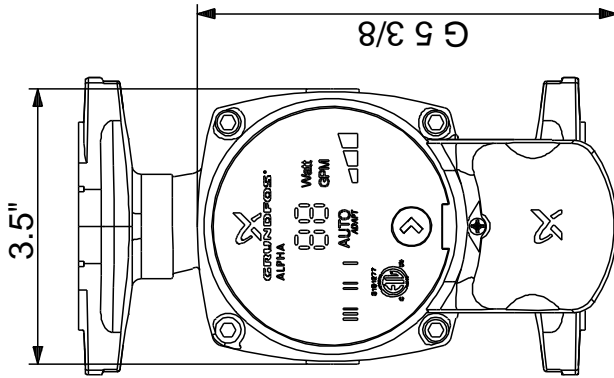

Note! All units are in [mm] unless others are stated.
Disclaimer: This simplified dimensional drawing does not show all details.

Position	Qty.	Description																																																
	1	<p data-bbox="322 163 478 194">UPS 43-100 F</p>  <p data-bbox="710 595 1193 622" style="text-align: center;">Note! Product picture may differ from actual product</p> <p data-bbox="322 629 587 656">Product No.: 95906636</p> <p data-bbox="322 658 845 741">The pump is of the canned rotor type, i.e. pump and motor form an integral unit without shaft seal and with only two gaskets for sealing.</p> <p data-bbox="322 743 850 770">The bearings are lubricated by the pumped liquid.</p> <p data-bbox="322 772 730 799">The pump has 3-step speed selector.</p> <p data-bbox="322 801 654 828">The pump is characterized by:</p> <ul data-bbox="359 831 901 981" style="list-style-type: none"> * Ceramic shaft and radial bearings. * Carbon axial bearing. * Stainless steel rotor can and bearing plate. * Corrosion-resistant impeller, Composite, PES. * Cast iron pump housing. <p data-bbox="322 1014 654 1041">The motor is a 1-phase motor.</p> <p data-bbox="322 1043 782 1070">No additional motor protection is required.</p> <p data-bbox="322 1104 406 1131">Liquid:</p> <table data-bbox="322 1133 817 1249"> <tr> <td>Pumped liquid:</td> <td>Water</td> </tr> <tr> <td>Liquid temperature range:</td> <td>0 .. 110 °C</td> </tr> <tr> <td>Liquid temp:</td> <td>60 °C</td> </tr> <tr> <td>Density:</td> <td>983.2 kg/m³</td> </tr> </table> <p data-bbox="322 1283 446 1310">Technical:</p> <table data-bbox="322 1312 794 1339"> <tr> <td>Approvals on nameplate:</td> <td>ETL, CSA</td> </tr> </table> <p data-bbox="322 1373 438 1400">Materials:</p> <table data-bbox="322 1402 865 1487"> <tr> <td>Pump housing:</td> <td>Cast iron EN-GJL-200</td> </tr> <tr> <td>Impeller:</td> <td>Composite, PES</td> </tr> </table> <p data-bbox="322 1520 462 1547">Installation:</p> <table data-bbox="322 1550 845 1787"> <tr> <td>Maximum ambient temperature:</td> <td>40 °C</td> </tr> <tr> <td>Amb. max at 80 dgr C liquid:</td> <td>80 °C</td> </tr> <tr> <td>Maximum operating pressure:</td> <td>10 bar</td> </tr> <tr> <td>Flange standard:</td> <td>USA Oval</td> </tr> <tr> <td>Type of connection:</td> <td>C.I. Flange</td> </tr> <tr> <td>Pipe connection:</td> <td>2 - Bolt Flange</td> </tr> <tr> <td>Pressure stage:</td> <td>10</td> </tr> <tr> <td>Port-to-port length:</td> <td>215 mm</td> </tr> </table> <p data-bbox="322 1821 502 1848">Electrical data:</p> <table data-bbox="322 1850 790 2105"> <tr> <td>C run:</td> <td>40 µF</td> </tr> <tr> <td>Power input in speed 1:</td> <td>265 W</td> </tr> <tr> <td>Power input in speed 2:</td> <td>335 W</td> </tr> <tr> <td>Max. power input:</td> <td>370 W</td> </tr> <tr> <td>Rated power - P2:</td> <td>0.25 kW</td> </tr> <tr> <td>Mains frequency:</td> <td>60 Hz</td> </tr> <tr> <td>Rated voltage:</td> <td>1 x 115 V</td> </tr> <tr> <td>Current in speed 1:</td> <td>2.5 A</td> </tr> <tr> <td>Current in speed 2:</td> <td>3.1 A</td> </tr> </table>	Pumped liquid:	Water	Liquid temperature range:	0 .. 110 °C	Liquid temp:	60 °C	Density:	983.2 kg/m ³	Approvals on nameplate:	ETL, CSA	Pump housing:	Cast iron EN-GJL-200	Impeller:	Composite, PES	Maximum ambient temperature:	40 °C	Amb. max at 80 dgr C liquid:	80 °C	Maximum operating pressure:	10 bar	Flange standard:	USA Oval	Type of connection:	C.I. Flange	Pipe connection:	2 - Bolt Flange	Pressure stage:	10	Port-to-port length:	215 mm	C run:	40 µF	Power input in speed 1:	265 W	Power input in speed 2:	335 W	Max. power input:	370 W	Rated power - P2:	0.25 kW	Mains frequency:	60 Hz	Rated voltage:	1 x 115 V	Current in speed 1:	2.5 A	Current in speed 2:	3.1 A
Pumped liquid:	Water																																																	
Liquid temperature range:	0 .. 110 °C																																																	
Liquid temp:	60 °C																																																	
Density:	983.2 kg/m ³																																																	
Approvals on nameplate:	ETL, CSA																																																	
Pump housing:	Cast iron EN-GJL-200																																																	
Impeller:	Composite, PES																																																	
Maximum ambient temperature:	40 °C																																																	
Amb. max at 80 dgr C liquid:	80 °C																																																	
Maximum operating pressure:	10 bar																																																	
Flange standard:	USA Oval																																																	
Type of connection:	C.I. Flange																																																	
Pipe connection:	2 - Bolt Flange																																																	
Pressure stage:	10																																																	
Port-to-port length:	215 mm																																																	
C run:	40 µF																																																	
Power input in speed 1:	265 W																																																	
Power input in speed 2:	335 W																																																	
Max. power input:	370 W																																																	
Rated power - P2:	0.25 kW																																																	
Mains frequency:	60 Hz																																																	
Rated voltage:	1 x 115 V																																																	
Current in speed 1:	2.5 A																																																	
Current in speed 2:	3.1 A																																																	

Position	Qty.	Description
		Current in speed 3: 3.5 A Capacitor size - run: 40 µF/180 V Number of poles: 2 Insulation class (IEC 85): H Others: Gross weight: 8.38 kg

PROJECT: _____	UNIT TAG: _____	QUANTITY: _____
REPRESENTATIVE: _____	TYPE OF SERVICE: _____	DATE: _____
ENGINEER: _____	SUBMITTED BY: _____	DATE: _____
CONTRACTOR: _____	APPROVED BY: _____	DATE: _____
	ORDER NO.: _____	DATE: _____

UPS 43-100 SF

Circulator pumps



Product photo could vary from the actual product

Conditions of Service	Pump Data	Motor Data
Flow: _____	Maximum operating pressure: 145 psi	Max. power input: 370 W
Head: _____	Liquid temperature range: 32 .. 230 °F	Rated power - P2: 0.33 HP
Efficiency: _____	Maximum ambient temperature: 104 °F	Rated voltage: 230 V
Liquid: Water	Approvals: ETL, CSA	Main frequency: 60 Hz
Temperature: 140 °F	Type of connection: S.S. Flange	Insulation class: H
NPSH required: ft	Flange standard: USA Oval	Motor protection: CONTACT
Viscosity: _____	Pipe connection: 2 - Bolt Flange	Thermal protection: internal
Specific Gravity: 0.985	Product number: 95906639	

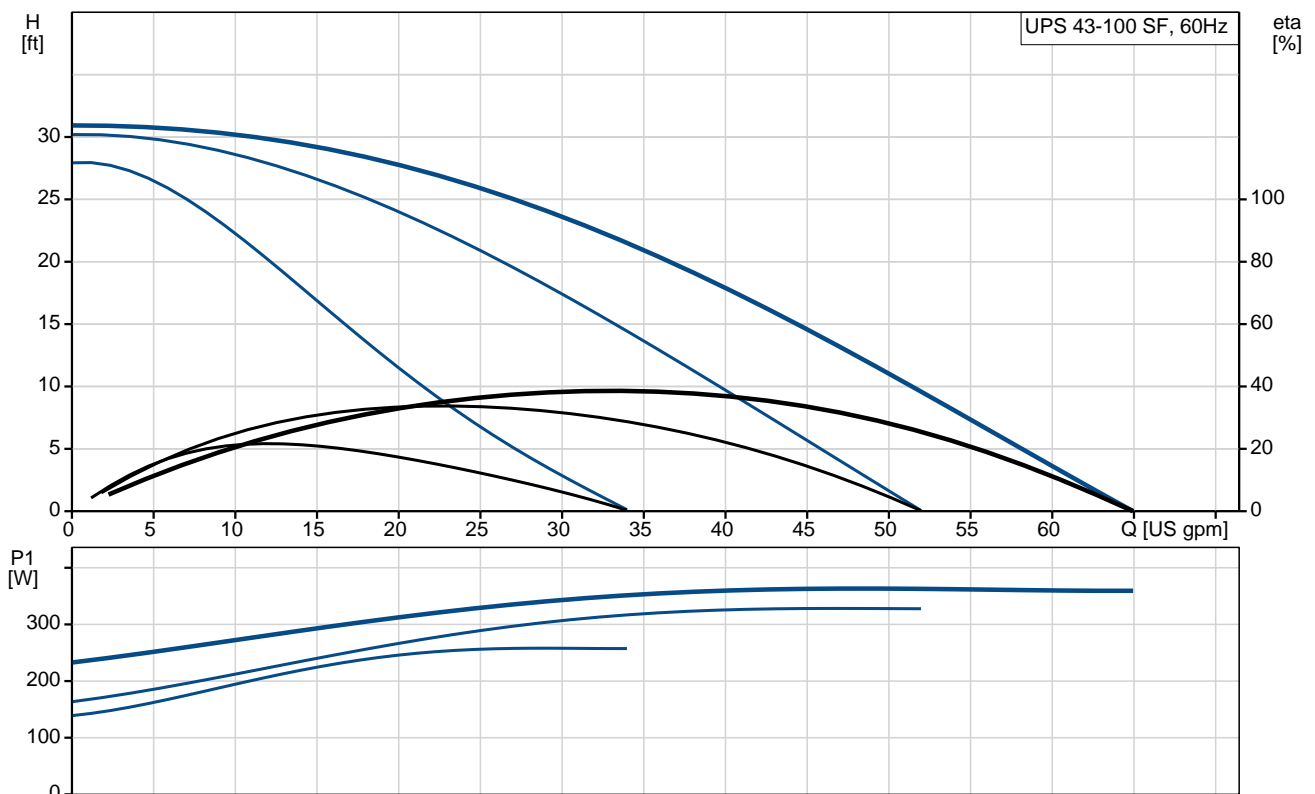

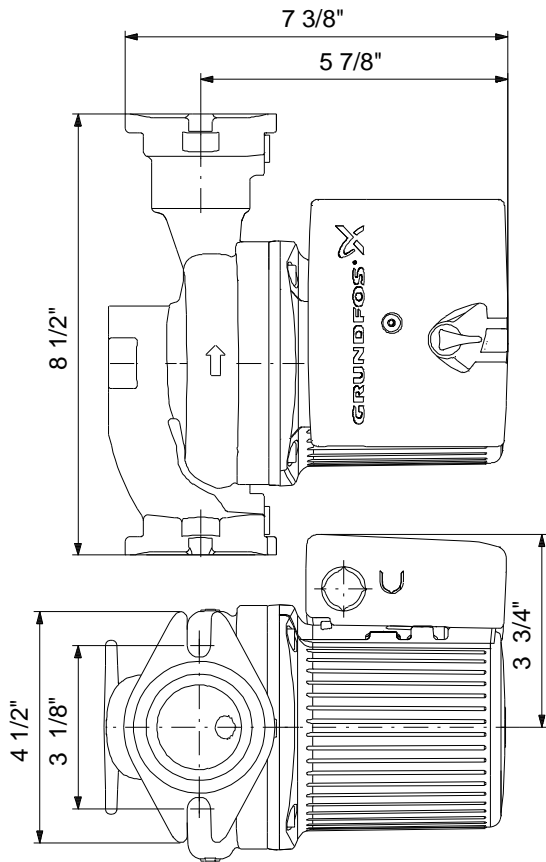

Materials:

- Pump housing: Stainless steel
DIN W.-Nr. 1.4301
- Impeller: Composite, PES

Position	Count	Description																																						
	1	<p>UPS 43-100 SF</p>  <p style="text-align: center;">Product photo could vary from the actual product</p> <p>Product No.: 95906639</p> <p>The pump is of the canned rotor type, i.e. pump and motor form an integral unit without shaft seal and with only two gaskets for sealing. The bearings are lubricated by the pumped liquid. The pump is characterized by:</p> <ul style="list-style-type: none"> * Ceramic shaft and radial bearings. * Carbon axial bearing. * Stainless steel rotor can and bearing plate. * Corrosion-resistant impeller, Composite, PES. * Stainless steel pump housing. <p>The motor is a 1-phase motor. No additional motor protection is required.</p> <p>Liquid:</p> <table> <tr> <td>Pumped liquid:</td> <td>Water</td> </tr> <tr> <td>Liquid temperature range:</td> <td>32 .. 230 °F</td> </tr> <tr> <td>Q_OpFluidTemp:</td> <td>140 °F</td> </tr> <tr> <td>Density:</td> <td>61.35 lb/ft³</td> </tr> </table> <p>Technical:</p> <table> <tr> <td>Approvals on nameplate:</td> <td>ETL, CSA</td> </tr> </table> <p>Materials:</p> <table> <tr> <td>Pump housing:</td> <td>Stainless steel DIN W.-Nr. 1.4301</td> </tr> <tr> <td>Impeller:</td> <td>Composite, PES</td> </tr> </table> <p>Installation:</p> <table> <tr> <td>Maximum ambient temperature:</td> <td>104 °F</td> </tr> <tr> <td>Ambient max at 176°F liquid:</td> <td>176 °F</td> </tr> <tr> <td>Maximum operating pressure:</td> <td>145 psi</td> </tr> <tr> <td>Flange standard:</td> <td>USA Oval</td> </tr> <tr> <td>Type of connection:</td> <td>S.S. Flange</td> </tr> <tr> <td>Pipe connection:</td> <td>2 - Bolt Flange</td> </tr> <tr> <td>Pressure stage:</td> <td>10</td> </tr> <tr> <td>Port-to-port length:</td> <td>8 1/2 in</td> </tr> </table> <p>Electrical data:</p> <table> <tr> <td>C run:</td> <td>10 µF</td> </tr> <tr> <td>Power input in speed 1:</td> <td>265 W</td> </tr> <tr> <td>Power input in speed 2:</td> <td>335 W</td> </tr> <tr> <td>Max. power input:</td> <td>370 W</td> </tr> </table>	Pumped liquid:	Water	Liquid temperature range:	32 .. 230 °F	Q_OpFluidTemp:	140 °F	Density:	61.35 lb/ft ³	Approvals on nameplate:	ETL, CSA	Pump housing:	Stainless steel DIN W.-Nr. 1.4301	Impeller:	Composite, PES	Maximum ambient temperature:	104 °F	Ambient max at 176°F liquid:	176 °F	Maximum operating pressure:	145 psi	Flange standard:	USA Oval	Type of connection:	S.S. Flange	Pipe connection:	2 - Bolt Flange	Pressure stage:	10	Port-to-port length:	8 1/2 in	C run:	10 µF	Power input in speed 1:	265 W	Power input in speed 2:	335 W	Max. power input:	370 W
Pumped liquid:	Water																																							
Liquid temperature range:	32 .. 230 °F																																							
Q_OpFluidTemp:	140 °F																																							
Density:	61.35 lb/ft ³																																							
Approvals on nameplate:	ETL, CSA																																							
Pump housing:	Stainless steel DIN W.-Nr. 1.4301																																							
Impeller:	Composite, PES																																							
Maximum ambient temperature:	104 °F																																							
Ambient max at 176°F liquid:	176 °F																																							
Maximum operating pressure:	145 psi																																							
Flange standard:	USA Oval																																							
Type of connection:	S.S. Flange																																							
Pipe connection:	2 - Bolt Flange																																							
Pressure stage:	10																																							
Port-to-port length:	8 1/2 in																																							
C run:	10 µF																																							
Power input in speed 1:	265 W																																							
Power input in speed 2:	335 W																																							
Max. power input:	370 W																																							



Company name:

Created by:

Phone:

Date:

5/18/2017

Position	Count	Description
		Rated power - P2: 0.33 HP Main frequency: 60 Hz Rated voltage: 1 x 230 V Current in speed 1: 1.2 A Current in speed 2: 1.5 A Current in speed 3: 1.7 A Capacitor size - run: 10 μ F/400 V Number of poles: 2 Insulation class (IEC 85): H Others: Gross weight: 17.7 lb

PROJECT: _____	UNIT TAG: _____	QUANTITY: _____
REPRESENTATIVE: _____	TYPE OF SERVICE: _____	DATE: _____
ENGINEER: _____	SUBMITTED BY: _____	DATE: _____
CONTRACTOR: _____	APPROVED BY: _____	DATE: _____
	ORDER NO.: _____	DATE: _____



UP 26-99 BF

Circulator pumps

Product photo could vary from the actual product

Conditions of Service	Pump Data	Motor Data
Flow: _____	Maximum operating pressure: 145 psi	Max. power input: 245 W
Head: _____	Liquid temperature range: 32 .. 230 °F	Rated power - P2: 0.16 HP
Efficiency: _____	Maximum ambient temperature: 104 °F	Rated voltage: 115 V
Liquid: Water	Approvals: UL, CSA	Main frequency: 60 Hz
Temperature: 140 °F	Type of connection: Bronze Flange	Insulation class: F
NPSH required: ft	Flange standard: USA Oval	Motor protection: CONTACT
Viscosity: _____	Pipe connection: 2 - Bolt Flange	Thermal protection: internal
Specific Gravity: 0.985	Product number: 52722347	



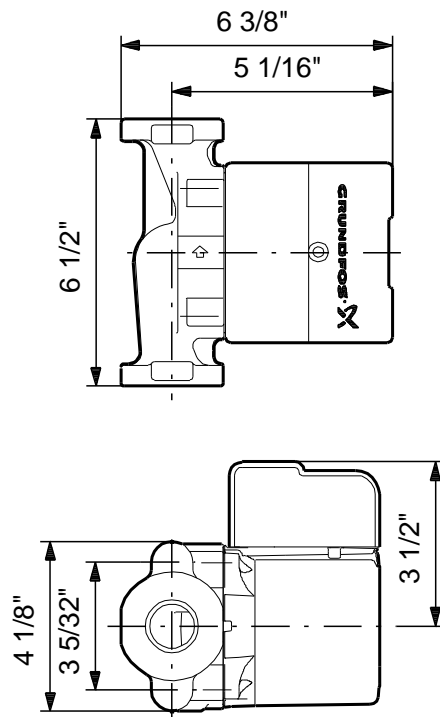

Materials:

Pump housing: Bronze
DIN W.-Nr. 2.1176.01
Impeller: Composite, PES

Position	Count	Description																																														
	1	<p>UP 26-99 BF</p>  <p style="text-align: center;">Product photo could vary from the actual product</p> <p>Product No.: 52722347</p> <p>The pump is of the canned rotor type, i.e. pump and motor form an integral unit without shaft seal and with only two gaskets for sealing. The bearings are lubricated by the pumped liquid. The pump is characterized by:</p> <ul style="list-style-type: none"> * Ceramic shaft and radial bearings. * Carbon axial bearing. * Stainless steel rotor can and bearing plate. * Corrosion-resistant impeller, Composite, PES. * Bronze pump housing. <p>The motor is a 1-phase motor. No additional motor protection is required.</p> <p>Liquid:</p> <table> <tr> <td>Pumped liquid:</td> <td>Water</td> </tr> <tr> <td>Liquid temperature range:</td> <td>32 .. 230 °F</td> </tr> <tr> <td>Q_OpFluidTemp:</td> <td>140 °F</td> </tr> <tr> <td>Density:</td> <td>61.35 lb/ft³</td> </tr> </table> <p>Technical:</p> <table> <tr> <td>Approvals on nameplate:</td> <td>UL, CSA</td> </tr> </table> <p>Materials:</p> <table> <tr> <td>Pump housing:</td> <td>Bronze</td> </tr> <tr> <td></td> <td>DIN W.-Nr. 2.1176.01</td> </tr> <tr> <td>Impeller:</td> <td>Composite, PES</td> </tr> </table> <p>Installation:</p> <table> <tr> <td>Maximum ambient temperature:</td> <td>104 °F</td> </tr> <tr> <td>Ambient max at 176°F liquid:</td> <td>176 °F</td> </tr> <tr> <td>Maximum operating pressure:</td> <td>145 psi</td> </tr> <tr> <td>Flange standard:</td> <td>USA Oval</td> </tr> <tr> <td>Type of connection:</td> <td>Bronze Flange</td> </tr> <tr> <td>Pipe connection:</td> <td>2 - Bolt Flange</td> </tr> <tr> <td>Pressure stage:</td> <td>10</td> </tr> <tr> <td>Port-to-port length:</td> <td>6 1/2 in</td> </tr> </table> <p>Electrical data:</p> <table> <tr> <td>C run:</td> <td>10 µF</td> </tr> <tr> <td>Max. power input:</td> <td>245 W</td> </tr> <tr> <td>Rated power - P2:</td> <td>0.16 HP</td> </tr> <tr> <td>Main frequency:</td> <td>60 Hz</td> </tr> <tr> <td>Rated voltage:</td> <td>1 x 115 V</td> </tr> <tr> <td>Current in speed 3:</td> <td>2.15 A</td> </tr> <tr> <td>Capacitor size - run:</td> <td>10 µF/180 V</td> </tr> </table>	Pumped liquid:	Water	Liquid temperature range:	32 .. 230 °F	Q_OpFluidTemp:	140 °F	Density:	61.35 lb/ft ³	Approvals on nameplate:	UL, CSA	Pump housing:	Bronze		DIN W.-Nr. 2.1176.01	Impeller:	Composite, PES	Maximum ambient temperature:	104 °F	Ambient max at 176°F liquid:	176 °F	Maximum operating pressure:	145 psi	Flange standard:	USA Oval	Type of connection:	Bronze Flange	Pipe connection:	2 - Bolt Flange	Pressure stage:	10	Port-to-port length:	6 1/2 in	C run:	10 µF	Max. power input:	245 W	Rated power - P2:	0.16 HP	Main frequency:	60 Hz	Rated voltage:	1 x 115 V	Current in speed 3:	2.15 A	Capacitor size - run:	10 µF/180 V
Pumped liquid:	Water																																															
Liquid temperature range:	32 .. 230 °F																																															
Q_OpFluidTemp:	140 °F																																															
Density:	61.35 lb/ft ³																																															
Approvals on nameplate:	UL, CSA																																															
Pump housing:	Bronze																																															
	DIN W.-Nr. 2.1176.01																																															
Impeller:	Composite, PES																																															
Maximum ambient temperature:	104 °F																																															
Ambient max at 176°F liquid:	176 °F																																															
Maximum operating pressure:	145 psi																																															
Flange standard:	USA Oval																																															
Type of connection:	Bronze Flange																																															
Pipe connection:	2 - Bolt Flange																																															
Pressure stage:	10																																															
Port-to-port length:	6 1/2 in																																															
C run:	10 µF																																															
Max. power input:	245 W																																															
Rated power - P2:	0.16 HP																																															
Main frequency:	60 Hz																																															
Rated voltage:	1 x 115 V																																															
Current in speed 3:	2.15 A																																															
Capacitor size - run:	10 µF/180 V																																															



Company name:

Created by:

Phone:

Date:

5/18/2017

Position	Count	Description
		Number of poles: 2 Insulation class (IEC 85): F
		Others: Gross weight: 11.5 lb